

**IT'S YOUR
SHABBOS**

**IT'S YOUR
ERUV!**

SUPPORT YOUR ERUV

Los Angeles
Community Eruv

Tax ID: 95-3287926

By the Community, For the Community.

FUNDING THE ERUV

The LA ERUV relies on the support of the community to fund its operations and ongoing maintenance. Family dues currently cover approximately half of the annual operating budget. Annual Eruv dues are \$100 per member family and are collected through participating community shuls. Each year, we rely on our Annual Eruv Shabbos Appeal to help fund the balance of the budget and maintain the eruv at the highest possible standards.

Please consider making a commitment to support the LA ERUV.

Families celebrating a simcha or wishing to honor the memory of a loved one may sponsor a week of the eruv for \$250. Donations may be made by check, credit card, Zelle, or PayPal at LAERUV.com.

The City of Los Angeles presents engineering and construction challenges far more complex than those faced by most other eruvim. The scale of the city, the complexity of its street and freeway systems, and the sheer size of the eruv make the LA ERUV one of the most technically demanding metropolitan eruvim in the world to maintain.

Unlike many eruvim that rely heavily on simple boundaries, the LA ERUV incorporates miles of solid walls, installed fencing, adapters, lines, and poles throughout the city. This allows the eruv to meet a significantly higher halachic standard, but also requires substantial physical infrastructure, ongoing construction coordination, and continuous maintenance.

The annual operating budget for the LA ERUV is approximately \$120,000. The largest share of the budget supports our maintenance and inspection teams, including the repair crew that spends hours every Thursday night — and often Friday — maintaining and repairing the eruv, as well as the rabbinical inspectors who check the eruv every week.

Over one-half of the annual budget is allocated toward materials and outside labor, including poles, fencing, connectors, construction labor, fence installation, sign companies, tree removal, and maintenance for our dedicated lift truck.

The remaining budget supports insurance requirements — including CalTrans, liability, workers' compensation, directors and officers (D&O), and vehicle insurance — along with administrative and operational expenses.

This year, the community also undertook a special campaign to finance the purchase of a new dedicated eruv maintenance truck.

One of the most technically demanding metropolitan eruvim in the world to maintain, incorporating miles of solid walls, fencing, lines, and poles throughout the city.



By the Community, For the Community.

LA ERUV BOUNDARIES

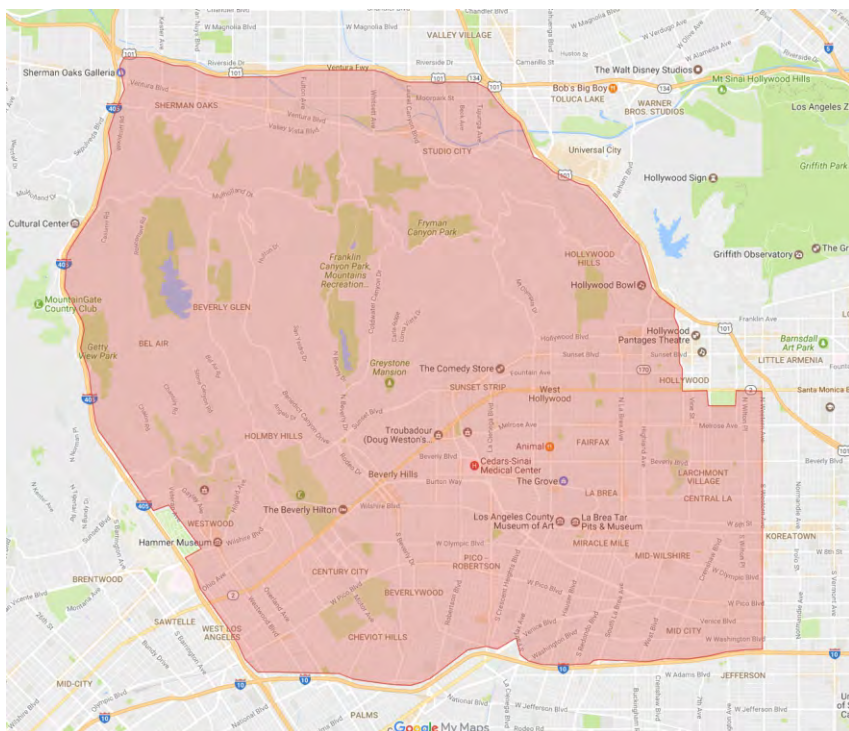

The LA Eruv boundary (southeast corner) begins at the corner of the 10 Freeway and Western Avenue, continues north on Western Avenue to Santa Monica Blvd., turns west on Santa Monica Blvd. to Caheunga Blvd., and then continues north to the 101 Freeway. The eruv boundary continues northwest on the south side of the 101 Freeway to the 405 Freeway, continues south on the east side of the 405 Freeway to the 10 Freeway, and continues east on the north side of the 10 Freeway to Western Avenue. The exact path is subject to change as we continually adjust to construction projects and other issues.

**HAVING
GUESTS
THIS
SHABBOS?
SUPPORT YOUR ERUV**

By the Community, For the Community.

USING AN ERUV

Many people make the mistake of assuming that an eruv creates permission to carry any object on Shabbos. An eruv is not a legal fiction, nor is it a workaround to allow the performance of the otherwise forbidden malacha of "Carrying". The concept of eruv is part and parcel of the halachos of Shabbos, and permits carrying only within narrow constraints.

Common articles that are permitted to be used or carried within an eruv on Shabbos include:

- Baby carriages and strollers.
- Canes, walkers and wheelchairs.
- Food, medicine.
- Handkerchiefs, gloves and rain hats.
- House keys.
- Siddur or sefer.

You should never assume that the eruv is "UP" for Shabbos.

You are required to take personal responsibility to check the eruv status before each Shabbos.

An eruv does not lend permission to carry any "muktzah" article. Some of the more common items that are not permitted to be carried include:

- Any item which has no Shabbos functional use such as stones & credit cards.
- Any item of great value which you would be very careful to protect such as passports, checks and other expensive items.
- Any item which cannot be used on Shabbos or whose intended use is for after Shabbos such as car keys or an umbrella.
- Bicycles and roller skates.

The eruv was built to enhance the experience of Shabbos, offering more togetherness, better access to shul, and additional options for the young and elderly. In order to use the eruv properly, we should remind ourselves as to what the Shabbos experience means.

You should never assume that the eruv is "UP" for Shabbos. You are required to take personal responsibility to check the eruv status before each Shabbos. You can check the LAERUV.com website, call 877-Eruv-Info, sign up for the email blast, join our WhatsApp group, check our Facebook or Twitter, or call a friend.

An eruv is a true blessing, and even a necessity for a community, but it shouldn't be treated lightly or lead you to forget that it is Shabbos. You should discuss with your own Rav the parameters of when and how to use the eruv.



By the Community, For the Community.

KEEPING THE ERUV UP Built to Last. Built to Adapt.

The Los Angeles Eruv was completed and first went live for Rosh Hashanah in 2002. More than 1,250 weeks later, it continues to serve the community every Shabbos.

Maintaining an eruv on this scale requires a constant balance between permanence and flexibility. The system must be constructed to remain operational continuously for decades, while also being adaptable enough to respond quickly to construction, roadwork, utility projects, and other city activities that can affect or remove portions of the boundary.

Over the years, the LA ERUV has become an established part of the city's infrastructure. Through decades of coordination and cooperation, our team has become familiar to city officials, engineers, inspectors, contractors, and the professionals responsible for building and maintaining infrastructure throughout Los Angeles.

When Caltrans rebuilt the 405 Freeway, our team participated directly in the design coordination process, meeting weekly with engineers to ensure that the eruv boundary remained intact throughout construction. Today, when contractors need to move street lights, remove fencing, or build structures that affect our boundaries, city engineers and inspectors routinely direct them to coordinate with us so that we can reroute or protect the eruv in advance.



“Maintaining an eruv on this scale requires a constant balance between permanence and flexibility.”

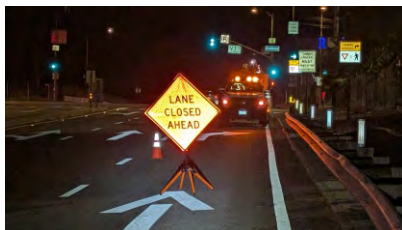
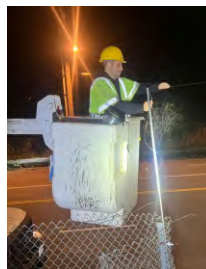

By the Community, For the Community.

KEEPING THE ERUV UP Closing Every Gap

As one of the largest eruv in the world, the LA ERUV has an enormous footprint throughout the city. The boundary relies on freeway fencing, sound walls, railway barriers, concrete walls, wildlife fencing, and other permanent structures along most of its perimeter.

Along the remaining sections, the boundary runs through city streets using 200-pound-test monofilament line extending from pole top to pole top.

Where the eruv crosses streets, freeway ramps, alleys, sidewalks, stairways, bridges, and other openings throughout the city, every gap must be carefully closed and maintained. Nowhere in the 45-mile perimeter is there a gap larger than a few inches.

Throughout Los Angeles, utility poles are fitted with custom adapters that were designed specifically for the LA ERUV. Over the years, we have shared both adapters and adapter designs with eruvim across the country.

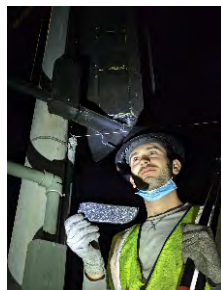

“Nowhere in the 45-mile perimeter is there a gap larger than a few inches.”



**TAKING
YOUR BABY
ON A
SHABBOS
WALK?
SUPPORT YOUR ERUV**

By the Community, For the Community.

KEEPING THE ERUV UP Every week. Every Shabbos.

Keeping the eruv functional and halachically sound week after week requires the coordinated efforts of rabbis, inspectors, and maintenance specialists.

Each week, our rabbinic inspection team traces the entire route of the eruv, checking poles, lines, fences, and structural connections for both physical integrity and halachic acceptability.

After each inspection, the rabbis prepare a detailed repair and maintenance list that includes both active issues and preventative maintenance items necessary for the ongoing health of the eruv.

Every Thursday night, our maintenance crew heads out in a bucket truck to complete the required repairs and adjustments before Shabbos.

Once the work is completed, the repair list is reviewed with the supervising Rav, who issues a psak confirming that the eruv is up — and the city is set for Shabbos.

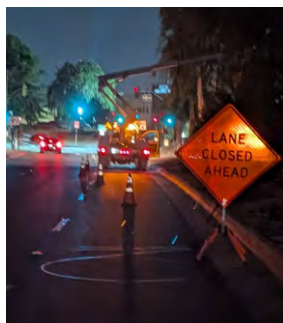

“Every Thursday night, our maintenance crew heads out to prepare the city for Shabbos.”



**HOSTING A
SIMCHA
THIS
SHABBOS?
SUPPORT YOUR ERUV**

By the Community, For the Community.

KEEPING THE ERUV UP The Truck That Keeps the Eruv Moving

Our bucket truck is central to our ability to maintain and repair the eruv efficiently and safely. When the eruv was first established, we relied on outside sign companies to dispatch trucks and crews to assist with repairs. The arrangement was expensive, inflexible, and dependent on outside scheduling and availability.

To solve this problem, we purchased our own truck, trained our crews to operate it, and assumed responsibility for managing repairs ourselves. When the original truck finally failed, it was replaced in 2016. After years of heavy use and thousands of repair hours, that truck also began to fail near the end of 2025.

“The new truck represents a major investment in the long-term reliability and safety of the LA ERUV.”

In December 2025, the community launched a special campaign to help fund the purchase of a replacement truck. Thanks to the generosity of the community, we were able to purchase a newer used truck with the required lift equipment while remaining within budget.

Over the following weeks, the truck was extensively upgraded and customized specifically for eruv maintenance operations. Improvements included:

- New safety lighting and warning signage
- Custom storage cabinets and repair bins
- Dedicated pole storage for poles up to 20 feet long
- Organized storage for repair hardware and replacement parts
- Tool charging systems
- Radio communications equipment
- Upgraded crew safety equipment and tools



These improvements made the truck safer, more efficient, and better suited for the unique demands of maintaining the eruv across Los Angeles.

The new truck represents a major investment by the community in the long-term reliability, safety, and maintenance of the LA ERUV.

We are deeply grateful to everyone who contributed to helping ensure that our crews have the tools and resources necessary to keep the eruv functioning every week.

By the Community, For the Community.

Shul Partners

Adas Torah	Jewish Learning Exchange	Pico Mesivta
Ateres Israel	JFK	Pinto
Bais Yehuda	Kahal Chasidim	Rubin
Bait Aharon	Kehilas Yaakov	Shaarei Tefila
Bait Knesset Ohr HaEmet	Kehillat Bnai Torah	Shteible
Beis Knesses of Los Angeles	Keshet Torah	Shuvah
Beth Jacob	Knesset Israel	TILA
BMH	Kollel Mercaz HaTorah	Westside Shul
B'nai David-Judea	Library Shul	Westwood Kehilla
Chabad	LINK Kollel	Yavneh
Chabad Beverlywood	Magen Avot	YAYOC
Chabad SOLA	Mogen David	YICC
Chassidish Kollel	MSS	YIHP
Community Shul	Nessah	YINBH
East Robertson Minyan	Ohel Moshe	YILA
Happy Minyan	Ohr HaChaim	Young Sephardic
Hillel	Pico Bais Midrash	

Builders & Pillars

We thank those families who gave to the LA Eruv through significant donations, including the following:

Adler	Farberov	Kaplan	Sobel
Anziska	Fenigstein	Katz	Spinrad
Aranoff	Fletcher	Kopple	Stieglitz
Balter	Friedman	Kramer	Toczek
Barzideh	Fund	Krombach	Wachtel
Bemel	Garmaise	Lipman	Winter
Berger	Grodzinski	Malk	Witkin
Berkowitz	Hager	Miller	Zemel
Buchman	Hanasabzadeh	Nagel	
Denbo	Hantman	Rbibio	
Eisenberg	Haridim	Rosenberg	
Elishis	Horowitz	Ryzman	
Essas	Isaacs	Schochet	
Farah	Kapenstein	Schoen	



By the Community, For the Community.

Guardians & Sponsors

We thank the more than 700 families contributed to the LA ERUV last year, including the following:

Sign up for a monthly support of the eruv at: www.laeruv.com/donate

Abesera	Cohen	Grama	Korda	Molayem	Saltiel	Tehrani
Abikhzer	Cooper	Grawitzky	Korobkin	Mollaei	Sameyah	Teichman
Abrams	Coronel	Green	Kramer	Moorvitch	Sariashvili	Teller
Abramson	Danishefsky	Greenberg	Krell	Mordecai	Sarto	Ten
Adison	Davenport	Greenes	Krevoy	Morell	Schiff	Tendler
Adivi	Davis	Greer	Krich	Morris	Schlecter	Toczek
Afergut	Dayan	Grodzinski	Krief	Moses	Schoen	Toren
Almog	Denbo	Gross	Kroll	Muchnik	Schperberg	Toubi
Alter	Deutsch	Gruen	Krombach	Muhstein	Schrage	Tretlet
Alyeshmerni	Drazin	Hack	Kuppermann	Muskin	Schuller	Tureff
Amar	Drucker	Hacohen	Kurzman	Nagel	Schultz	Union
Amster	Druker	Hager	Ladenheim	Neissany	Schwartzman	Uretsky
Anvar	Eiluz	Hak	Lalezarian	Neumann	Sebban	Vann
Appel	Eisenberg	Halberstam	Landa	Noorani	Segura	Vidlikan
Arfa	Elefant	Haller	Landman	Nourafchan	Seleh	Vizel
Astrof	Elishis	Hanasabzadeh	Lansky	Otes	Seliger	Vosoghi
Atanelov	Elkus	Hans	Lebovics	Otkha	Selya Cohen	Wachtel
Atlas	Elterman	Hantman	Lee	Opos	Shabo	Waghalter
Aufrichtig	Engel	Haridim	Leeb	Palatchi	Shadrooz	Weinberger
Avital	Epstein	Hascalovici	Lerer	Panahi	Shafigi	Weinman
Avitan	Escovitz	Hausman	Leventhal	Panitz	Shahery	Weiskopf
Axelrod	Eskin	Hazan	Levine	Pariser	Shallman	Wiener
Baal	Etshalom	Hecht	Levinson	Partush	Shamekh	Wiesel
Bader	Factor	Heikaly	Levy	Peikon	Shanblatt	Wilf
Baitelman	Farah	Hendel-Giller	Liebenthal	Peled	Shapiro	Wilner
Balter	Fax	Hershoff	Liebhard	Pell	Sharf	Wilker
Banafsheha	Feigenbaum	Heyman	Lieder	Perlmutter	Shaye	Willner
Barkhordar	Feispor	Hill	Lifshitz	Pesso	Shear	Wilnai
Barnett	Feldman	Hirschhorn	Light	Polon	Shemtoob	Winkler
Barzideh	Fenig	Hirschman	Link	Pomeranz	Shemtov	Winter
Baseri	Fenigstein	Hoffman	Linkovsky	Prero	Shenker	Wintner
Baum	Ferszt	Homami	Lipman	Presser	Sher	Wisnicki
Bayanfar	Fhima	Homapour	Lipstein	Price	Shink	Witkin
Beck	Fialkoff	Horowitz	Litenatsky	Pritikin	Shirakhoon	Wizenfeld
Beltran	Fihman	Huttler	Lobell	Pryce	Shmagin	Wolmark
Bemel	Fine	Isaacs	Loboda	Quinn	Shoff	Yacoby
Benarroch	Firestone	Ishal	Loewenstein	Rabbanian	Shriki	Yagolnister
Benyowitz	Fishbein	Jacobs	Lowi	Rabin	Shuchat	Yaris
Berger	Fishman	Jaffe	Luger	Rabinowitz	Silverman	Yellen
Berkowitz	Flicker	Jakubovitz	Lurie	Rahimian	Simon	Yeroushalmi
Berlin	Flinkman	Javanfar	Lynn	Ratner-Stauber	Simons	Youkhehpaz
Berman	Foundation	Kahen	Mainstain	Razi	Singer-Frankes	Zagha
Bernstein	Frankel	Kahn	Makabi	Rbibo	Slate	Zaghi
Berookm	Fraser	Kalinsky	Malk	Refua	Small	Zajac
Bess	Fried	Kandel	Manela	Reichman	Smilow	Zakowski
Bibi	Friedman	Kanefsky	Manor	Reiffman	Smith	Zamanzadeh
Blaker	Fuchs	Kapenstein	Marks	Revah	Sobel	Zaret
Blauner	Funk	Kaplan	Masjedi	Rich	Socher	Zargari
Bloch	Ganchrow	Karmel	Maslow	Richards	Soleimani	Zemel
Blumenstrauch	Garmaise	Karpeles	Matanky	Richeimer	Soleymani	Zilkha
Boldt	Gerendash	Karz	Mavashav	Ritz	Solomon	Zisblatt
Bonert	Gewirtz	Kasdan	May	Romm	Sommer	Zyslat
Bookstein	Giller	Katchen	Mayesh	Rose	Spain	
Bornstein	Gindi	Katz	Mazar	Rosen	Spinrad	
Braum	Ginsberg	Kauffman	Mazouz	Rosenbaum	Starr	
Braun	Girl	Kaufman	Mckenney	Rosenberg	Steiner	
Brisk	Glaser	Keiter	Medina	Rosenblum	Steinmetz	
Brooks	Glazer	Kestenbaum	Meier	Rosenstein	Stephen	
Bruk	Gluck	Kimia	Meisels	Rosenthal	Stern	
Buchman	Gofman	Kirschenbaum	Meitlis	Ross	Stewart	
Burton	Golcchek	Kishineff	Mellon	Rothschild	Stolz	
Cahn	Goldberg	Klein	Mendelsohn	Rothstein	Streicher	
Cahman	Goldenberg	Kleinman	Meschaninov	Rottenberg	Stuhl	
Caplan	Goldner	Klempner	Messri	Rutz	Subar	
Carron	Goldstein	Kohانبash	Metal	Rutner	Sullivan	
Casen	Gordon	Kohanchi	Meyer	Ryzman	Szames	
Casper	Gorman	Kohanooff	Miller	Saadat	Talansky	
Cavaliar	Gottlieb	Kohengadol	Milstein	Sabel	Tashman	
Cegla	Grabel	Kohn	Mishulovin	Sachs	Tatarsky	
Chaimovitz	Grabie	Konstantin	Mog	Sadik	Tatarsky	
Cofsky	Gradon	Kopple	Mokhtar	Safran	Taylor	





Los Angeles Community Eruv
1120 S Robertson Blvd, Suite 300
Los Angeles, CA 90035

www.laeruv.com
info@laeruv.com



laeruv.com/donate